



VALORE

ANTONIADES

RESIDENTIAL COMPOUND



DISCLAIMER

All specifications, features and contents in the Master Plan were correct at the time of printing and are subject to change at the Developer's discretion without prior notification.

Plans and elevations are artist's renderings and may contain options which are not standard on all models. All dimensions are approximate and subject to change at the Developer's discretion without prior notification.

The sketches, renderings, graphic materials, plans, specifications, terms, conditions and statements contained in this brochure are proposed only, and the Developer reserves the right to modify, revise or withdraw any or all of same in their sole discretion and without prior notice.



RESIDENTIAL COMPOUND

A view that inspires life

About Valore Company

نبذة عن شركة فالورى

WORD ORIGIN AND HISTORY



c.1300, "value, worth," from Old French valour "*strength, value, valor, قيمة, أهمية, قوة*," from Late Latin valorem (nominative valor) "*value, worth,*" from stem of Latin valere "be worth, be strong". The meaning "courage" is first recorded 1580s, from Italian valore, from the same Late Latin word. (The Middle English word also had a sense of "*worth or worthiness in respect of manly qualities*").



Valore Company for real estate investment has been founded as a result of the cooperation between big investment groups in Egypt, which are **ELGHONEMY** Group and **ELRIYADH** Group (Castel).

The initial vision from the foundation date was concentrated so as Valory will be considered among the biggest companies in the field of real estate investment all over Egypt. The evidence of the above mentioned is the distinguished character of the first project of the new company in Alexandria, to be executed in excellent places, with big and varied numbers of units. Valory for real estate investment has its specific vision, which is offering high quality of products and services and the complete satisfaction of the customers.

تأسست فالورى للاستثمار العقارى، وهى نتاج التعاون بين كبرى المجموعات الاستثمارية فى مصر وهى **مجموعة الغنيمى** و**مجموعة الرياض** (كاسيل).

وتم وضع الرؤية منذ التأسيس لتكون فالورى من كبريات الشركات فى مجال الاستثمار العقارى فى جميع انحاء مصر . والدليل على ما تم ذكره ان اولى مشروعات الشركة فى الاسكندرية ذات طابع مميز واماكن متميزة وباعداد كبيره ومتنوعه من الوحدات . ووضعت فالورى للاستثمار العقارى الرؤية الخاصة بها وهى تقديم منتجات وخدمات ذات جودة متفوقه والرضا التام للساده العملاء .



VALORE
ANTONIADES



Morning View

RESIDENTIAL COMPOUND





RESIDENTIAL COMPOUND



Extraordinary Family Experience

حياة عائلية رائعة



The experience that you have never had before... In Valore you don't have to worry about your kids while playing outside as we guarantee the highest level of security everywhere... after a long working day there are Spa and Gym waiting for you to taste relaxation and wellbeing... If you forgot getting what is needed for home; there are Valore malls including everything you want...

VALORE what is needed for a safe family

التجربة التي لم تعهدها من قبل... مع فالوري ليس عليك ان تقلق علي أطفالك حين يلعبوا بالخارج فنحن نضمن لك أعلى درجات الأمان في كل مكان في الكومباوند... بعد يوم عمل طويل ستجد مركز سبا وجيم في استقبالك لامدادك بالراحة و الحفاظ علي صحتك... أن نسيت ما يجب أحضاره لمستلزمات البيت لا عليك, هناك مراكز تجارية مزودة بكل شيء تريده.

فالوري.. كل ما تحتاجه لعائلة آمنة

RESIDENTIAL COMPOUND



Valore... An Eye to the future

فالوري... نظرة إلى المستقبل

We deliver a new concept of compound residence; it is not just a compound it is a small town which is provided by Children Park to let your child enjoy every moment, shopping centers to let your wife do her favorite hobby, gym, SPA and green areas for a better health and Eye satisfaction... If you have the opportunity to make their life better Just choose it!!

What your family dreams about... is already in Valore.

نحن نطلق مفهوم مختلف عن السكن في كومة باوند، انه ليس مجرد كومة باوند بل هو مدينة صغيرة مزودة بملاعب اطفال ليستمتعوا بكل لحظة، مراكز تجارية حتي تدع زوجتك تمارس هواياتها المفضلة و ايضا مراكز جيم و سبا و مساحات خضراء لصحة افضل و لراحة الأعين... إذا كان لديك الفرصة لجعل حياتهم أفضل..فاخترها اذا!!

ما تحلم به عائلتك... موجود في فالوري

 VALORE
ANTONIAADES

RESIDENTIAL COMPOUND

A Summary About The Site

نبذة عن الموقع

Valore is a city in a core of a city , so you won't be isolated as we're at the core of Alexandria near to the public services and roads and looking Antoniaades Gardens where the legacy and classy art also on New AL-Mahmoudia Axis which is considered as the biggest project of roads development in Alexandria ...

Valore looks over the history to construct the future.

فالوري مدينة في قلب مدينة, لذا لن تصبح معزولاً لأننا في قلب الاسكندرية بالقرب من المرافق و الخدمات و الطرق العامة, يطل كومباوند فالوري علي حدائق النطونبادس حيث العراقة و الفن الراقي و هو يقع على مشروع محور المحمودية الجديد الذي يعتبر أكبر مشروع مروري وتجاري لمحافظة الاسكندرية.

فالوري يطل علي التاريخ ليبنى مستقبل...



RESIDENTIAL COMPOUND

VALORE
ANTONIADES

Facilities

It is characterized by its purpose as a residential compound, provided with all utilities and services.

يتميز بأنه كومباوند سكني متكامل الخدمات وتشمل بعض هذه الخدمات.

- The highest quality of building materials.
- Gates and avenues constructed on a hotel basis.
- Lifts of high quality and imported from abroad.
- Security, guard and cleaning services.
- Surveillance cameras, covering all the compound corners.
- Maintenance services for 24 hours daily.
- Intercom connecting all the projects' units.
- Streets, squares and landscape.
- Green surfaces.
- Social club.
- Area for children care.
- First aid point.
- Commercial zone.
- Two story garage servicing customers in its whole area

- واجهات معمارية متميزه.
- اعلى جوده خامات فى مواد البناء.
- مداخل وطرق على الطراز الفندقى.
- مصاعد بجوده عاليه مستورده.
- خدمات الامن والحراسه والنظافه.
- كاميرات مراقبه تغطى كافة جوانب الكومباوند.
- خدمات صيانه ٢٤ ساعه.
- انتركم يربط جميع وحدات المشروع.
- شوارع وميادين ولاندسكيب.
- مسطحات خضراء.
- نادى اجتماعى.
- منطقة لرعاية الاطفال.
- نقطه اسعافات اوليه.
- منطقه تجاريه.
- عدد ٢ دور جراج بكامل المسطح.

Facilities



Children's Park
& Play Area



Gymnasium
& SPA

RESIDENTIAL COMPOUND



Facilities

Landscape Garden



Fiber Cable Internet



Facilities



Car Parking Space

Maintenance Services
For 24 Hours



RESIDENTIAL COMPOUND

Facilities

Shopping Center



Security
& Surveillance





VALORE
ANTONIADES



VALORE
ANTONIADES

RESIDENTIAL COMPOUND



Master Plan



RESIDENTIAL COMPOUND





Floor Plans



RESIDENTIAL COMPOUND

BUILDING A

- TYPE A1 : 247 m²
- TYPE A2 : 234 m²
- TYPE A3 : 256 m²
- TYPE A4 : 231 m²
- TYPE A5 : 211 m²



MASTER KEY PLAN

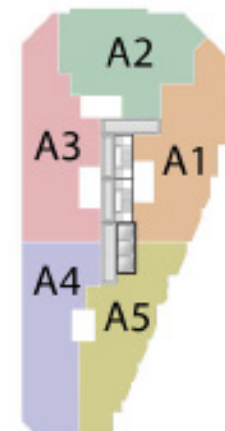

FLOOR KEY PLAN

BUILDING B

- TYPE B1 : 220 m²
- TYPE B2 : 199 m²
- TYPE B3 : 187 m²
- TYPE B4 : 218 m²
- TYPE B5 : 263 m²
- TYPE B6 : 213 m²



MASTER KEY PLAN



FLOOR KEY PLAN

BUILDING C

- TYPE C1 : 190 m²
- TYPE C2 : 196 m²
- TYPE C3 : 198 m²
- TYPE C4 : 190 m²



MASTER KEY PLAN



FLOOR KEY PLAN

RESIDENTIAL COMPOUND



BUILDING D

- TYPE D1 : 190 m²
- TYPE D2 : 173 m²
- TYPE D3 : 173 m²
- TYPE D4 : 190 m²



MASTER KEY PLAN

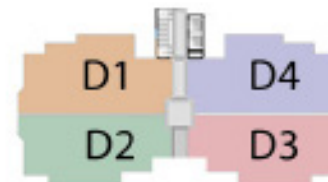

FLOOR KEY PLAN

BUILDING E

TYPE E1 : 173 m²

TYPE E2 : 177 m²

TYPE E3 : 179 m²

TYPE E4 : 177 m²



MASTER KEY PLAN



FLOOR KEY PLAN

RESIDENTIAL COMPOUND



BUILDING F

- TYPE F1 : 148 m²
- TYPE F2 : 182 m²
- TYPE F3 : 189 m²
- TYPE F4 : 163 m²



MASTER KEY PLAN

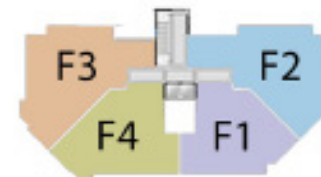

FLOOR KEY PLAN

BUILDING G

- TYPE G1 : 217 m²
- TYPE G2 : 198 m²
- TYPE G3 : 186 m²
- TYPE G4 : 222 m²
- TYPE G5 : 244 m²
- TYPE G6 : 209 m²

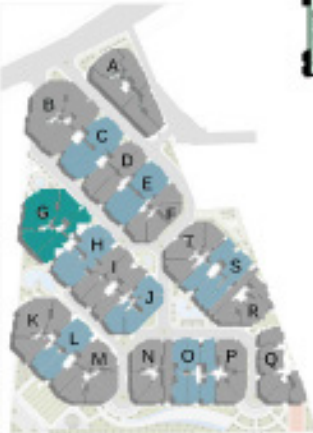

MASTER KEY PLAN



FLOOR KEY PLAN

RESIDENTIAL COMPOUND



BUILDING H

- TYPE H1 : 191 m²
- TYPE H2 : 153 m²
- TYPE H3 : 198 m²
- TYPE H4 : 195 m²



MASTER KEY PLAN



FLOOR KEY PLAN

BUILDING I

- TYPE I1 : 169 m²
- TYPE I2 : 198 m²
- TYPE I3 : 153 m²
- TYPE I4 : 153 m²
- TYPE I5 : 153 m²
- TYPE I6 : 169 m²



MASTER KEY PLAN



FLOOR KEY PLAN

RESIDENTIAL COMPOUND



BUILDING J

- TYPE J1 : 165 m²
- TYPE J2 : 182 m²
- TYPE J3 : 195 m²
- TYPE J4 : 161 m²



MASTER KEY PLAN



FLOOR KEY PLAN

BUILDING K

- TYPE K1 : 218 m²
- TYPE K2 : 230 m²
- TYPE K3 : 244 m²
- TYPE K4 : 209 m²



MASTER KEY PLAN

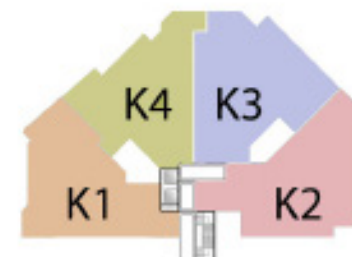

FLOOR KEY PLAN

RESIDENTIAL COMPOUND



BUILDING L

- TYPE L1 : 168 m²
- TYPE L2 : 169 m²
- TYPE L3 : 153 m²
- TYPE L4 : 153 m²



MASTER KEY PLAN



FLOOR KEY PLAN



RESIDENTIAL COMPOUND

BUILDING M

- TYPE M1 : 177 m²
- TYPE M2 : 187 m²
- TYPE M3 : 205 m²
- TYPE M4 : 169 m²
- TYPE M5 : 157 m²
- TYPE M6 : 196 m²



MASTER KEY PLAN



FLOOR KEY PLAN

RESIDENTIAL COMPOUND



BUILDING N

- TYPE N1 : 160 m²
- TYPE N2 : 172 m²
- TYPE N3 : 224 m²
- TYPE N4 : 172 m²
- TYPE N5 : 156 m²



MASTER KEY PLAN



FLOOR KEY PLAN

BUILDING O

- TYPE O1 : 168 m²
- TYPE O2 : 181 m²
- TYPE O3 : 142 m²
- TYPE O4 : 146 m²
- TYPE O5 : 147 m²
- TYPE O6 : 172 m²



MASTER KEY PLAN



FLOOR KEY PLAN

RESIDENTIAL COMPOUND



BUILDING P

- TYPE P1 : 172 m²
- TYPE P2 : 166 m²
- TYPE P3 : 168 m²
- TYPE P4 : 177 m²



MASTER KEY PLAN

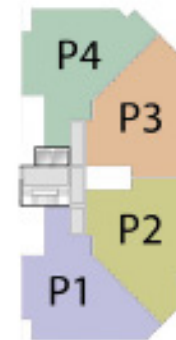

FLOOR KEY PLAN

BUILDING Q

- TYPE Q1 : 157 m²
- TYPE Q2 : 120 m²
- TYPE Q3 : 122 m²
- TYPE Q4 : 153 m²
- TYPE Q5 : 159 m²
- TYPE Q6 : 159 m²



MASTER KEY PLAN

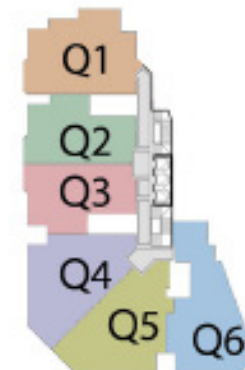

FLOOR KEY PLAN

RESIDENTIAL COMPOUND



BUILDING S

- TYPE S1 : 172 m²
- TYPE S2 : 213 m²
- TYPE S3 : 153 m²
- TYPE S4 : 153 m²
- TYPE S5 : 168 m²



MASTER KEY PLAN

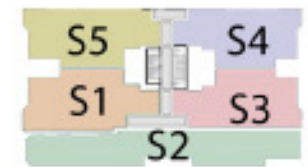

FLOOR KEY PLAN

RESIDENTIAL COMPOUND



BUILDING T

- TYPET1 : 194 m²
- TYPET2 : 185 m²
- TYPET3 : 185 m²
- TYPET4 : 195 m²



MASTER KEY PLAN



FLOOR KEY PLAN



RESIDENTIAL COMPOUND

DISCLAIMER

All specifications, features and contents in the Master Plan were correct at the time of printing and are subject to change at the Developer's discretion without prior notification.

Plans and elevations are artist's renderings and may contain options which are not standard on all models. All dimensions are approximate and subject to change at the Developer's discretion without prior notification.

The sketches, renderings, graphic materials, plans, specifications, terms, conditions and statements contained in this brochure are proposed only, and the Developer reserves the right to modify, revise or withdraw any or all of same in their sole discretion and without prior notice.



VALORE
ANTONIADES
RESIDENTIAL COMPOUND

-  Mahmoudiea Canal St.
Infront of Antoniades Gardens
Beside Alexandria Water Station
-  info@valore-eg.com
-  www.valore-eg.com

المؤسسون

HOTLINE
 15125

الغنيمي
El Ghonemy

الرياض
كامل
للتمويل والتأمين العقاري